

| DATE | SYMBOL | REVISION RECORD | AUTH. | D.R. | C.K. |
|----------|--------|-------------------|-------|------|------|
| 10/25/07 | A | REVISED & REDRAWN | | | 823 |
| 10/27/05 | B | ITEM 190 DELETED | | | 823 |
| | | | | | |
| | | | | | |

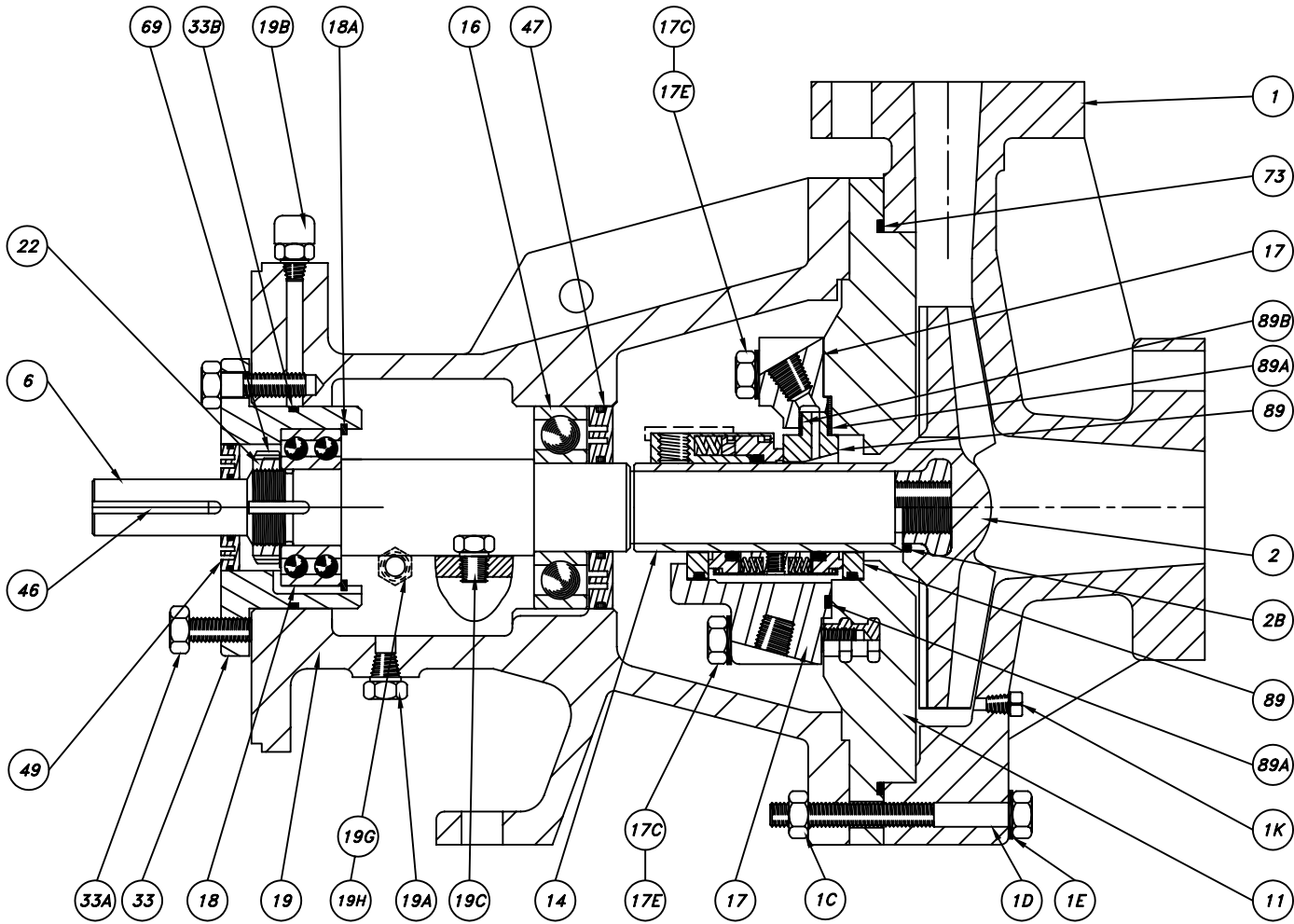

| PART# | DESCRIPTION | QTY. | MATERIAL |
|-------|-------------------------|------|----------------|
| 1 | CASING | 1 | VINYL ESTER |
| 1C | CASING NUT | 6 | 303 S.S. |
| 1D | CASING BOLT | 6 | 303 S.S. |
| 1E | CASING WASHER | 6 | 303 S.S. |
| 1K | DRAIN PLUG (opt.) | 1 | TEFLON |
| 2 | IMPELLER | 1 | VINYL ESTER |
| 2B | O-RING, IMPELLER (opt.) | 1 | VITON |
| 6 | SHAFT | 1 | 303 S.S. |
| 11 | COVER | 1 | VINYL ESTER |
| 14 | SHAFT SLEEVE (opt.) | 1 | VINYL ESTER |
| 16 | BEARING INBOARD | 1 | STEEL |
| 17 | GLAND RING | 1 | VINYL ESTER |
| 17C | GLAND BOLT | 4 | 303 S.S. |
| 17E | GLAND WASHER | 4 | 303 S.S. |
| 18 | BEARING OUTBOARD | 1 | STEEL |
| 18A | SNAP RING | 1 | STEEL |
| 19 | FRAME | 1 | CAST IRON |
| 19A | OIL DRAIN PLUG | 1 | STEEL |
| 19B | BREATHER | 1 | STEEL |
| 19C | OIL FILL PLUG | 1 | STEEL |
| 19G | SIGHT GLASS | 1 | STEEL/GLASS |
| 19H | SIGHT GLASS PLUG | 1 | STEEL |
| 22 | BEARING LOCKNUT | 1 | STEEL |
| 33 | BEARING HOUSING | 1 | CAST IRON |
| 33A | ADJUSTING SCREW | 6 | 303 S.S. |
| 33B | O-RING, BRG. HOUSING | 1 | BUNA |
| 46 | COUPLING KEY | 1 | 303 S.S. |
| 47 | LABY. SEAL INBRD. BRG. | 1 | BRZ/NICKEL PL |
| 49 | LABY. SEAL OUTBRD. BRG. | 1 | BRZ/NICKEL PL |
| 69 | LOCKWASHER | 1 | STEEL |
| 73 | O-RING, COVER | 1 | VITON |
| 89 | MECHANICAL SEAL | 1 | CARBON/CERAMIC |
| 89A | GLAND SEAL, COVER | 1 | VITON |
| 89B | GLAND SEAL, REAR | 1 | VITON |

Fybroc Division TELFORD, PA 18969
 1500 GROUP 1 SCALE DRAWN BY *823*
 1550 GROUP 1 APPROVED BY
 TITLE SECTIONAL DRAWING
 DATE 2/2/95 DRAWING NUMBER C50074-M REV. B