

DATE	SYM.	REVISION RECORD	AUTH.	D.R.	C.K.

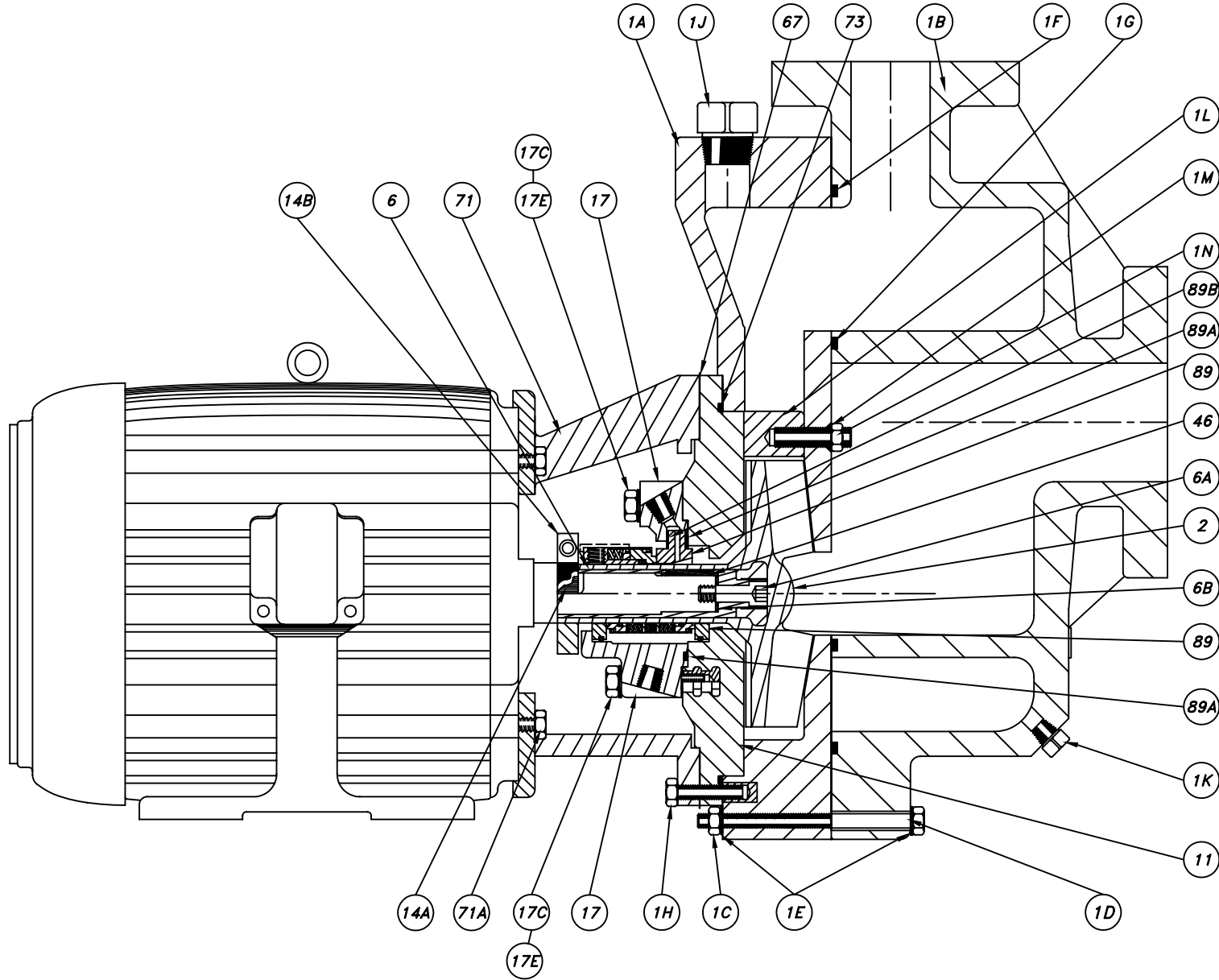

ITEM#	DESCRIPTION	QTY.	MATERIAL
1A	CASING, VOLUTE	1	VINYL ESTER
1B	CASING TANK	1	VINYL ESTER
1C	CASING, NUT	8-10	303 S.S.
1D	CASING BOLT	8-10	303 S.S.
1E	CASING WASHER	16-20	303 S.S.
1F	O-RING, DISCHARGE	1	VITON
1G	O-RING, SUCTION	1	VITON
1H	CASING SCREW	6	303 S.S.
1J	FILL PLUG	1	POLYPROPYLENE
1K	DRAIN PLUG (optional)	1	TEFLON
1L	VOLUTE INSERT	1	VINYL ESTER
1M	O-RING, INSERT	1-2	VITON
1N	INSERT NUT	1-2	VINYL ESTER
2	IMPELLER	1	VINYL ESTER
6	SHAFT	1	303 S.S.
6A	SHAFT SCREW	1	303 S.S.
6B	SHAFT WASHER	0-2	STEEL
11	COVER	1	VINYL ESTER
14A	SEGMENT KEY	1	VINYL ESTER
14B	LOCKING RING	1	POLYPROPYLENE
17	GLAND RING	1	VINYL ESTER
17C	GLAND, BOLT	4	303 S.S.
17E	GLAND, WASHER	4	303 S.S.
46	KEY	1	303 S.S.
67	SHIM (approx.)	12	ACRYLIC
71	PUMP ADAPTOR	1	CAST IRON
71A	SCREW, ADAPTOR-PUMP	4	303 S.S.
73	O-RING, COVER	1	VITON
89	MECHANICAL SEAL	1	CARBON/CERAMIC
89A	GLAND SEAL, COVER	1	VITON
89B	GLAND SEAL, REAR	1	VITON
-	MOTOR, JM FRAME	1	-

Fybroc Division		TELFORD, PA 18969	
1630 SERIES GROUP 1		SCALE ~	DRAWN BY <i>SLJ</i>
		APPROVED BY	
TITLE SECTIONAL DRAWING			
DATE 7/14/95	DRAWING NUMBER C50085-M	REV.	